

BAZOOKA-12KIT Installation Instructions



Notes:

1. This filter has an automatic shut off valve.
2. Replacement Bazooka filter available SKU: BAZOOKA

Instructions:

1. This BAZOOKA-12KIT will ship fully assembled. Dissassemble to locate Part 4 - Bulkhead Locking Nut. This piece will be used to mark the drain location. Use a pencil or silver marker to trace the inside of the locking nut.
2. Using a utility knife or scissors, carefully cut out the hole for the drain.
3. Assemble remaining pieces according to graphic below.

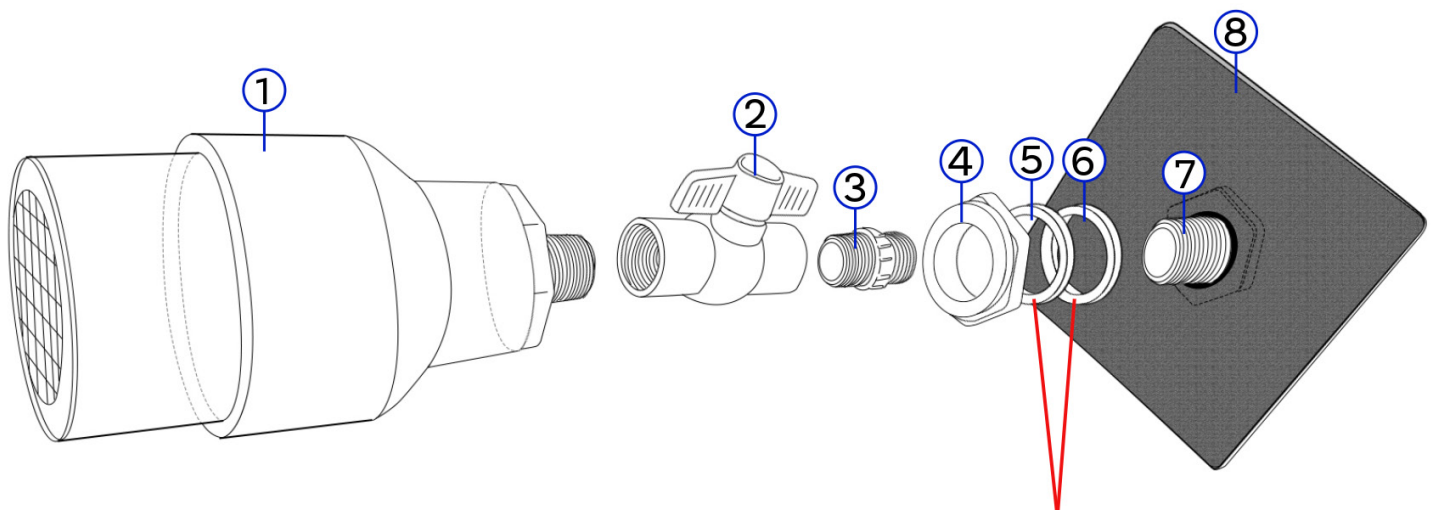

- | | |
|-----------------------------|--------------------------|
| 1. BAZOOKA Filter Cartridge | 5. Gasket - Outside Berm |
| 2. PVC Ball Valve | 6. Gasket - Inside Berm |
| 3. PVC Hex Nipple | 7. Bulkhead Flanged Body |
| 4. Bulkhead Locking Nut | 8. Pre-Filter Pouch |

Berm wall goes between Gaskets 5 and 6.

Watch the BAZOOKA-12KIT Installation Instructions on YouTube:

https://www.youtube.com/watch?v=kN_4Nc38bKg